

Lease start date: _____
 Monthly rent: _____
 Monthly utilities: _____
 Lease term: _____
 Notes: _____

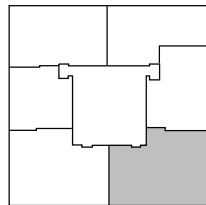

RANDOLPH ST. N†

FEATURES

- Soaring 9'6" ceilings
- Wide-plank flooring
- Open kitchens with back-painted glass upper cabinetry
- 3 cm quartz countertops with full height backsplash
- Bosch and Fisher Paykel integrated appliances
- Beverage center by Thermador
- Walk-in kitchen pantry

- Kohler fixtures and faucets
- Valli & Valli polished chrome hardware
- Spacious customized closets
- In-home washer & dryer
- Ecobee smart thermostats
- Roller shades
- Keyless entry